



**RECORD OF TITLE
UNDER LAND TRANSFER ACT 2017
FREEHOLD
Search Copy**



R. W. Muir
Registrar-General
of Land

Identifier NA116A/825
Land Registration District North Auckland
Date Issued 11 May 1999

Prior References

NA109A/619

Estate Fee Simple
Area 701 square metres more or less
Legal Description Lot 50 Deposited Plan 185734

Registered Owners

Andrew Colin Paulger and Karen Sheree Paulger

Interests

Land Covenant in Transfer 5364005.1 - 4.10.2002 at 9:18 am

Appurtenant hereto is a sanitary sewer darinage created by Transfer 5536291.1 - 28.3.2003 at 9:00 am

9253013.3 Mortgage to ASB Bank Limited - 5.12.2012 at 4:35 pm

Registered Owners
R. W. Bamings
 R.M. Bamings
 B.M. Bamings

Approved
[Signature]
 Planning Manager / Senior Surveyor/Planner

Approval pursuant to Section 223 of the Resource Management Act 1991. The proposed subdivision is subject to the Amendment Conditions set out hereon and subject to the granting or reserving of the easement set out in the Memorandum hereon the Common Seal of the Waitakere City Council is affixed hereto in the presence of

[Signature]
 Mayor

Amendment Conditions
 That Lot 36, DP 18550 be relic as to one undivided one third share by the owners of Lot 18 hereon as to one undivided one third share and as to one undivided one third share of the said shares and that the said shares be held as to two undivided one half shares by the owners of Lot 14B and 49 hereon as tenants in common in the said shares and that individual certificates of title be issued in accordance herewith.
 That Lot 14C hereon be relic as to two undivided one third shares by the owners of Lot 51 and 52 hereon as tenants in common in the said shares and that individual certificates of title be issued in accordance herewith.
 That Lot 5 hereon be relic as to three undivided one third shares by the owners of Lot 1, 54 and 55 hereon as tenants in common in the said shares and that individual certificates of title be issued in accordance herewith.
 See file A630542

Sheet 1 of 2
 Total Area 2.9154 ha
 Comprised in CT 109A/619

1. Main Map of Acreage
 Required survey and number of an actual measuring certificate in which may act as a registered survey pursuant to section 26 of the Survey Act 1980. Every survey that this plan has been made from survey created by an actual measuring certificate must be a registered survey pursuant to section 26 of the Survey Act 1980. The Survey Department 1972 or any subsequent date to registration must be registered in the Survey Department 1972 or any subsequent date to registration.
 Date of registration this plan is *[Signature]*
 of *[Signature]* is the Signature of *[Signature]*
 Full Name: *[Signature]* Town or Block: *[Signature]*
 Reference: *[Signature]*
 Approved to be Surveyed: *[Signature]*
 Chief Surveyor
 City of Auckland
 17/12/1999
 Deposited this 17/12/1999 by the Registrar-General of Land
 The Registrar-General of Land
 DP 1855734
 Approved 14/07/1997
 Registrar

Plan of Lots 1 to 5 and 47 to 55 being a subdivision of Lot 1 DP 176967

LAND DISTRICT: North Auckland
 Survey Blk. & Dist.: X Waitakere
 NZMS 261 Sheet: Record Map No.

TERRITORIAL AUTHORITY: Waitakere City Council
 Surveyed by: K. Morris
 Scale: 1:1000
 Date: Sep 1996

Areas shown (X) to be subject to Land Creation
 Memorandum of Easement in Gross
 Easement (shown) Servient Tenement
 Water Supply (C) Lot 18 hereon
 Mahurangi City Council

New Cadastral Features of Title Allocated
 Lot 1, 18A, 281 Lot 47
 Lot 2, 18A, 282 Lot 48
 Lot 3, 18A, 283 Lot 49
 Lot 4, 18A, 284 Lot 50
 Lot 5, 18A, 285 Lot 51
 Lot 6, 18A, 286 Lot 52
 Lot 7, 18A, 287 Lot 53
 Lot 8, 18A, 288 Lot 54
 Lot 9, 18A, 289 Lot 55

W 18174

27 MAY 1999

27 MAY 1998

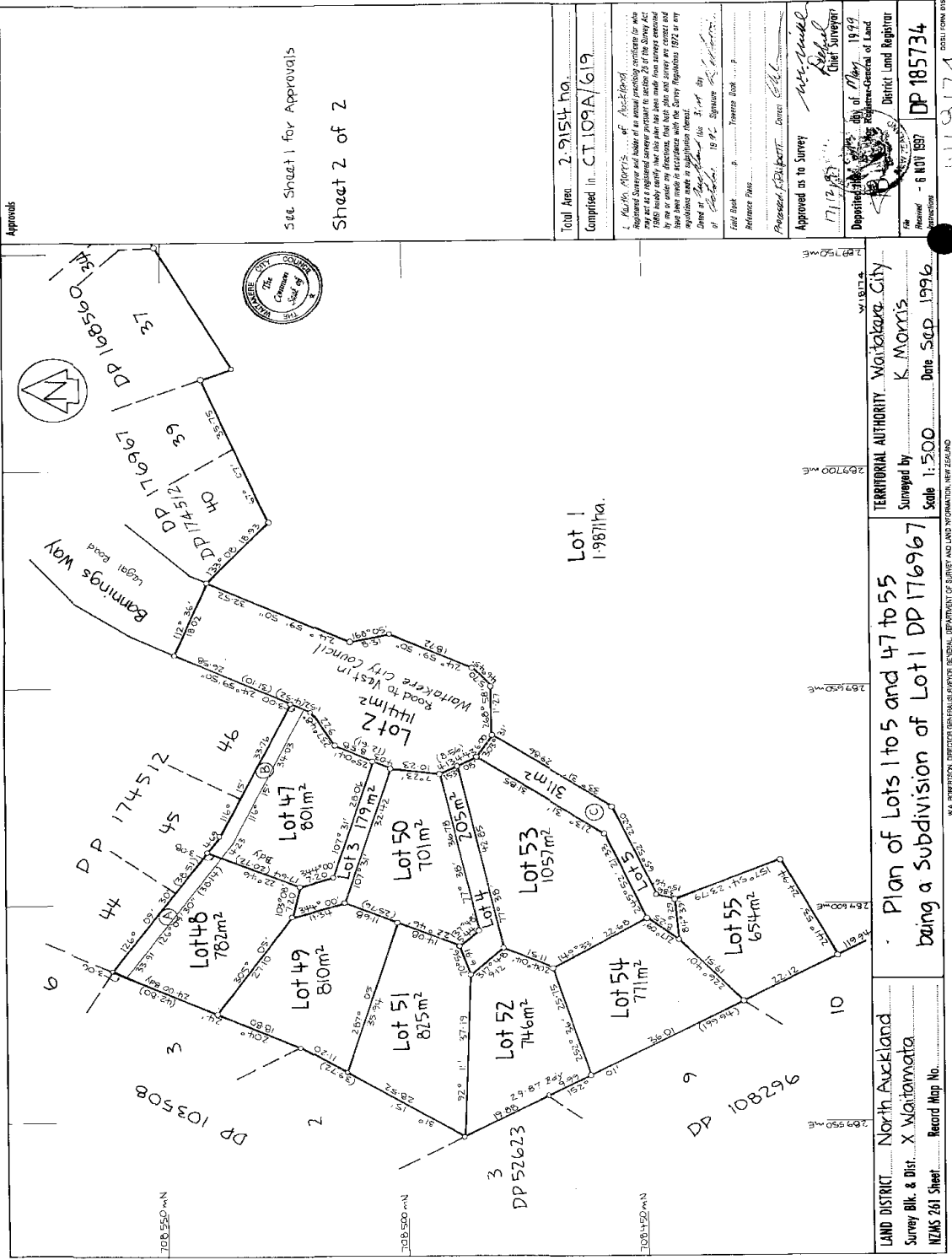

Approvals

See Sheet 1 for Approvals
Sheet 2 of 2

Total Area 2.9154 ha.
Comprised in... CT.109A/619

I, the Surveyor, do hereby certify that this plan has been made from surveys conducted by me or under my direction, that the lots are correctly surveyed and that the boundaries are correctly shown, and that the area is correctly stated.

Dated at Auckland this 21st day of May 1998.

Signature of Surveyor: *[Signature]*

Reference Plan: *[Blank]*

Approved as to Survey: *[Signature]*
17/12/98
Chief Surveyor

Deposited this 17th day of May 1998.
Registrar-General of Land

DP 185734
- 6 NOV 1997

W19174

LAND DISTRICT: North Auckland
Survey Blk. & Dist.: X Waitomata
NZMS 261 Sheet: Record Map No. *[Blank]*

TERRITORIAL AUTHORITY: Waitomata City
Surveyed by: K MORRIS
Scale: 1:500 Date: SEP 1996

Plan of Lots 1 to 5 and 47 to 55
being a subdivision of Lot 1 DP 176967

W.A. ROBERTSON, DIRECTOR GENERAL (PLANNING) (GENERAL), DEPARTMENT OF SURVEY AND LAND INFORMATION, 467 ZEALAND